

OPL



OPTILUX 1' x 4' air handling luminaires.

Ambient lighting balance between VDT task and surrounding area.

Precision formed, 4 1/4" deep cell low iridescent specular aluminum louver.

Louver assembly retained with T-hinges and spring loaded cam latches.

Die formed steel housing .
White polyester finish.

1' x 4'

T-GRID CEILING

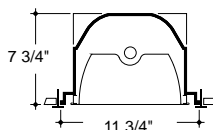

AIR FUNCTIONS	LAMPS	CAT. NO.	VOLTS*	BALLAST*
AIR SUPPLY / RETURN	1-32 W/T8	OPLA-14G-132-9-	120	ES
STATIC	1-32 W/T8	OPLS-14G-132-9-	120	ES
HEAT REMOVAL	1-32 W/T8	OPLH-14G-132-9-	120	ES
AIR SUPPLY / RETURN	1-40 W/T12	OPLA-14G-140-9-	120	ES
STATIC	1-40 W/T12	OPLS-14G-140-9-	120	ES
HEAT REMOVAL	1-40 W/T12	OPLH-14G-140-9-	120	ES

> For other ceiling type installation see catalog numbering code on PAGE 9, or consult factory.

> Air control / damper blades are available as an option.

* For other volts and ballast selection = SEE PAGE 9
ORDERING EX: CAT. NO. = **OPLA-14G-132-9-120-ES**