

LUMINAIRES FOR SURFACE or WALL MOUNTING

42

CI



One lamp.
 White opal acrylic wrap-around diffuser.
 Spring loaded end covers.
 Baked enamel finish - white or black.
 Thermally protected H.P.F. ballast.
 Ceiling or wall mounting.

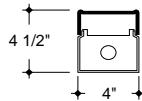

CN



One or two lamps.
 White opal acrylic wrap-around diffuser.
 Spring loaded end covers.
 Baked enamel finish - white or black.
 Thermally protected H.P.F. ballast.
 Ceiling or wall mounting.

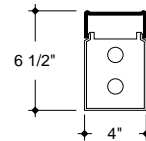

LAMPS	LENGTH	CAT. NO.	VOLTS*	BALLAST*
1-17 W/T8	24 3/4"	CIB-2-117-	120	ES
1-20 W/T12	24 3/4"	CIB-2-120-	120	STD
1-32 W/T8	48 3/4"	CIB-4-132-	120	ES
1-40 W/T12	48 3/4"	CIB-4-140-	120	ES
2-32 W/T8 **	97 1/2"	CIB-8-232-	120	ES
2-40 W/T12 **	97 1/2"	CIB-8-240-	120	ES

** TANDEM UNITS

LAMPS	LENGTH	CAT. NO.	VOLTS*	BALLAST*
1-17 W/T8	24 3/4"	CNB-2-117-	120	ES
1-20 W/T12	24 3/4"	CNB-2-120-	120	STD
1-32 W/T8	48 3/4"	CNB-4-132-	120	ES
1-40 W/T12	48 3/4"	CNB-4-140-	120	ES
2-32 W/T8 **	97 1/2"	CNB-8-232-	120	ES
2-40 W/T12 **	97 1/2"	CNB-8-240-	120	ES
2-17 W/T8	24 3/4"	CNB-2-217-	120	ES
2-20 W/T12	24 3/4"	CNB-2-220-	120	STD
2-32 W/T8	48 3/4"	CNB-4-232-	120	ES
2-40 W/T12	48 3/4"	CNB-4-240-	120	ES
4-32 W/T8 **	97 1/2"	CNB-8-432-	120	ES
4-40 W/T12 **	97 1/2"	CNB-8-440-	120	ES

** TANDEM UNITS

HT **SPECULAR**
 see page 17

*VOLTS	*BALLAST
120	ES = ENERGY SAVING
277	EL = ELECTRONIC
347	STD = STANDARD

NOTE: CIB & CNB models have **BLACK HOUSING**.
 For **WHITE HOUSING** replace CIB or CNB
 with CIW or CNW.

ORDERING EX: CAT. NO. = **CNB-4-140-120-ES**